

INSTRUCTIONS FOR RF FRAME INSTALLATION (1 3/4" THK. PANEL, RF 40 dB SLIP-IN PROFILE)

INSTALLATION INSTRUCTIONS

For the basic frame installation please reference IG#100. See below for Radio Frequency specific instructions for the installation of a slip-in RF frame.

RF SLIP-IN GROUNDING INSTRUCTIONS

The Krieger slip-in frame uses a simple design that allows more flexibility and offers an easy solution for the installation of RF applications. KSP slip-in frames can easily be installed post wall construction by removing the applied trim and placing the frame in the rough opening with the wall RF shielding film exposed to the trim face of the frame. Use the Krieger provided metalized, RF tape to secure the shielding to the frame. Install the SS removable trim back in place over the tape and RF shielding to create a complete RF seal around the entire frame. Please see Figure A below on how to properly connect the RF wall film to the KSP removable SS trim. Ensure no paint is applied to the contact point between the door and the silicone perimeter seal.

Note: Some gyp-board metal-stud partition types will require notching the stud, if a fitment conflict exists with the EPT's and/or DPS's mud-box.

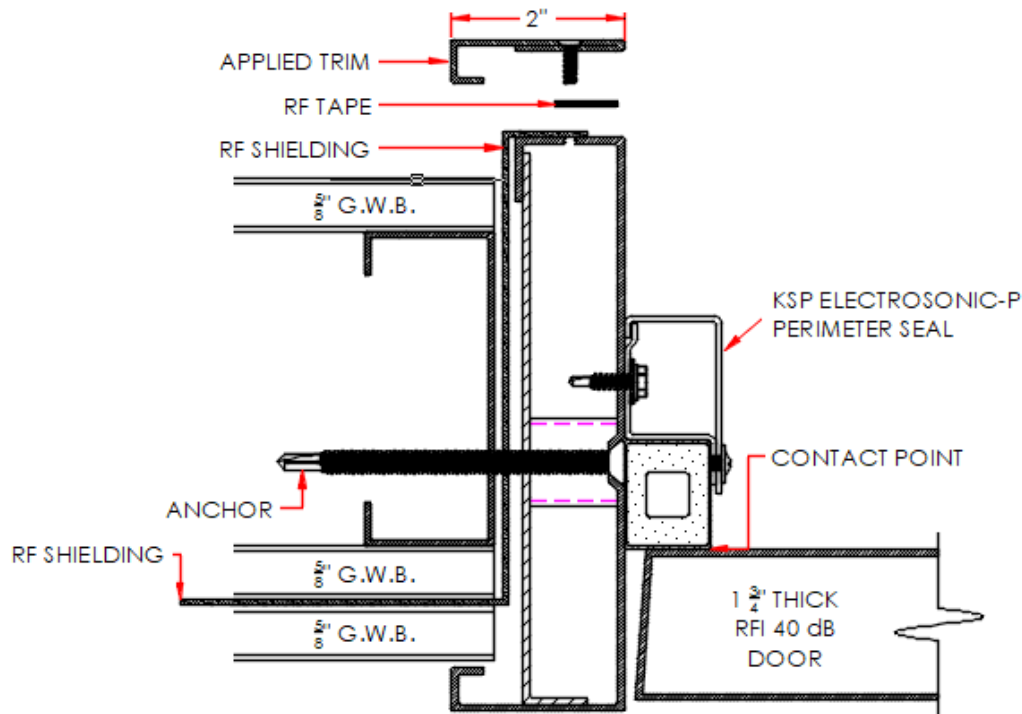

FIGURE A