



What to Know Before Getting Started

- When installing a frame with an STC rating of 51 or lower, the frame may be tightly packed with #8 density rock wool. When the STC rating is 52 or higher, the frame must be grouted solid.
- Any frame that is for an acoustical/radio frequency (RF) hybrid door, must use #8 density rock wool. RF and acoustical/RF hybrid frames cannot be grouted. Please refer to the Radio Frequency Installation Guides section for more information.



We're Here to Help

At Krieger, we understand every project is unique. If after reviewing this guide, you have any questions or concerns about installing, adjusting, or maintaining your Krieger product, our engineering department is here to help.

Please call us directly at **562-695-0645** or reach out to your regional sales representative.

Visit [kriegerproducts.com/contact/](https://www.kriegerproducts.com/contact/) for more information.



Made in the USA

All Krieger products are proudly designed and manufactured in the United States.

For Frames with Z Anchors or Nailing Clip Anchors

- Grout frame before installation.
- Leave the frame spreader bar attached.
- Place the frame in a horizontal position on saw horses, two or three frames of the same size can be stacked up and grouted at the same time.
- Our installers use and recommend “Gyps-O-Lite” by Gold Bond or “Struct-O-Lite” by United States Gypsum. Either of these products should be readily available at building material supply houses.
- Allow grout to fully set up before removing spreader bar and installing frame (see Installing Frame on the next page).

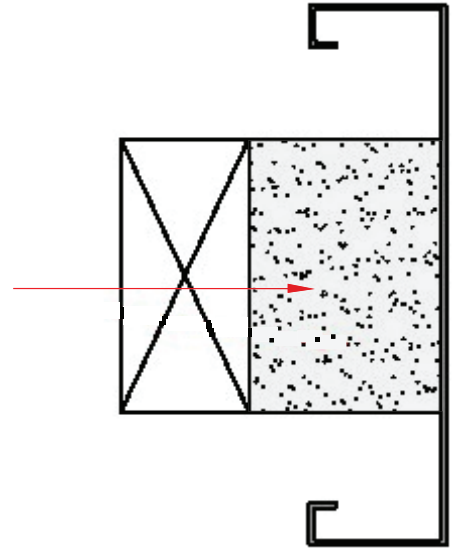

Z Anchors: (Metal Studs) Punch & Dimple

- Mix grout to a very thick consistency and dry pack group up to, but not over, the top of the Z anchors or straps if using a punch & dimple frame anchor.

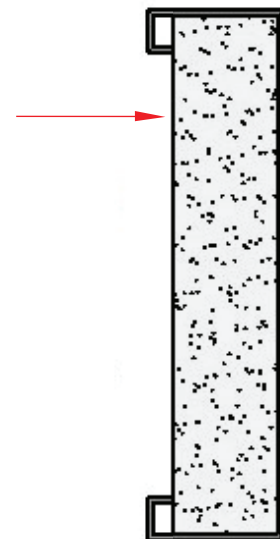

Nailing Clip Anchors (Wood Studs)

- Mix grout to a very thick consistency and dry pack grout to within $\frac{3}{4}$ " of returns. (This allows gypsum board to be recessed into throat of frame.)
- Nailing clips should protrude straight out for grouting (can be bent to install).

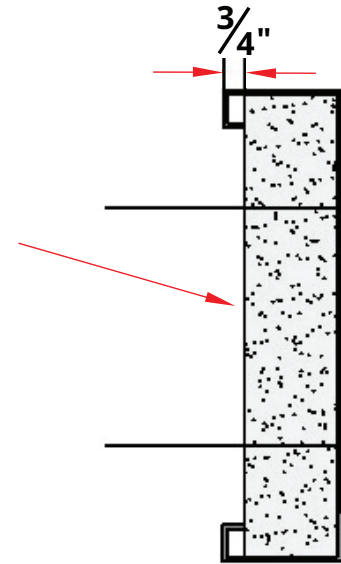

For Continuous Channel Anchors (Wood or Metal Studs)

- Grout frame after installation, remove the frame spreader bar, and install frame (see Installing Frame below).
- The frame can be installed and the jambs framed in leaving a boxed in compartment into which the grout can be poured. Before pouring grout into jambs, drop in two or three cups of dry grout mix into each jamb; this will help seal bottom of jambs against run out. Pour until jambs and head are full, then frame in head. Grout should be consistency of thick mud.

Rev. 2-072624

Installing Frame

STEP 1

- Use only solid heavy-duty box metal studs with no holes in the web.

NOTE: 25-gauge “Tin Can” studs are **NOT** recommended.

STEP 2

- Set frame in position with the jambs plumb and in plane. Then with the head level, being particularly careful with pairs, weld or screw through studs into anchors.

STEP 3

- Caulk the entire edge of the sheet rock that will butt up against the grout as shown in (A). Sheet rock is to be installed as deeply into the frame as possible, including all layers at multi-layer installations.
- Also, continuously caulk the joint shown at (B) on both sides of the wall and around the entire perimeter of the frame; our installers use and recommend "USG Acoustical Caulking."

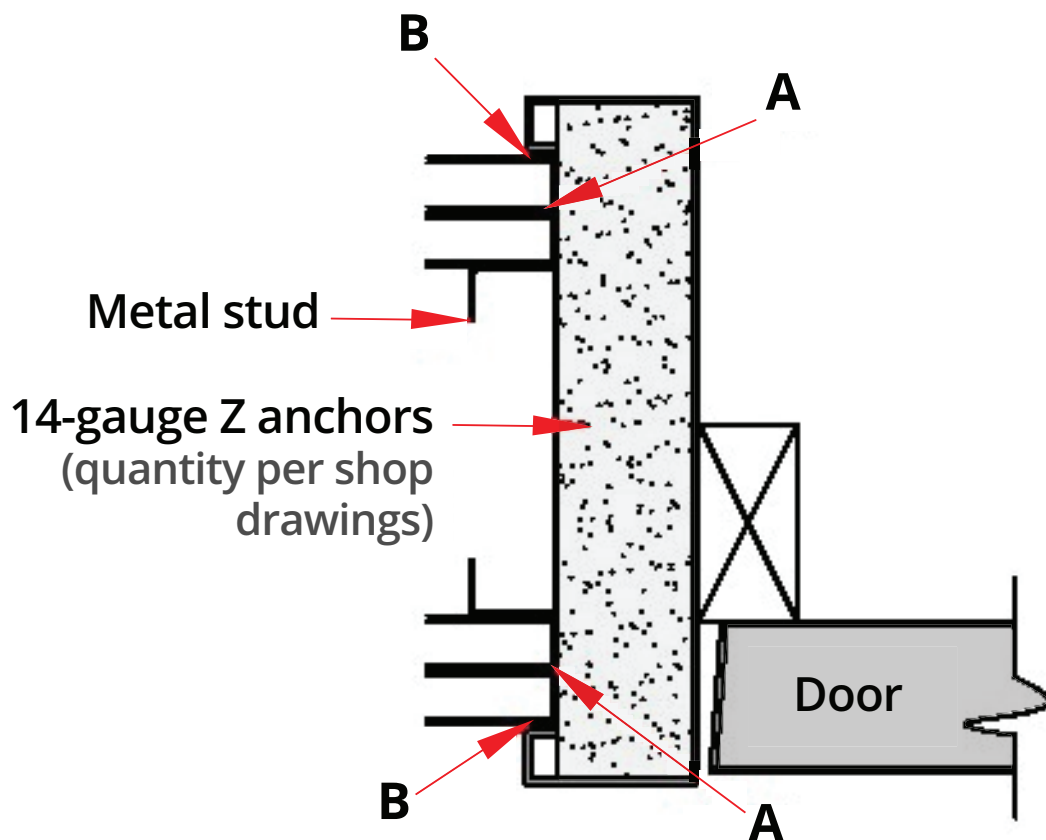

End Instructions

Rev. 2-072624