

# INSTRUCTIONS FOR RF/ ACOUSTIC FRAME INSTALLATION

## INSTALLATION INSTRUCTIONS

For the basic frame installation please reference IG#100. See below for Radio Frequency specific instructions for the installation of a RF/ Acoustic frame.

### RF GROUNDING FLANGE

The main difference with a RF frame installation is how it grounds to the room. Krieger uses a full perimeter stainless steel grounding flange to interface the rooms construction. The position of the grounding flange varies in location. Please reference your submittal package for the placement of the grounding flange and where it will interface into the wall. Once the frame is secure and the grounding flange lines up with the room grounding film you can seal it with the Krieger provided metalized tape. A roll will be included with your order and it is important to seal the full perimeter of the flange. Please see figure (A, B) below on how to properly connect the RF Flange to the room grounding material.

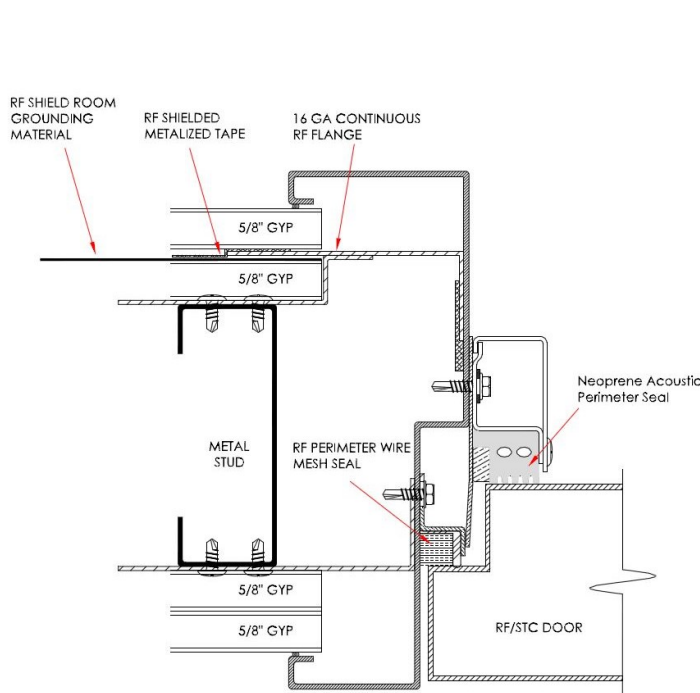

**FIGURE A**

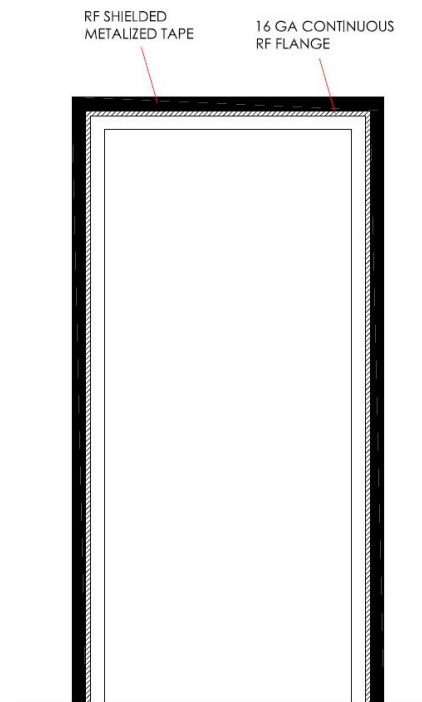

**FIGURE B**