

GLASS AND GLAZING

MATERIALS NEEDED

- Glazing blocks
- Glazing Tape
- Caulking, DOW 995 or similar product.

Note: incorrect caulking may damage inner layer of laminating glass

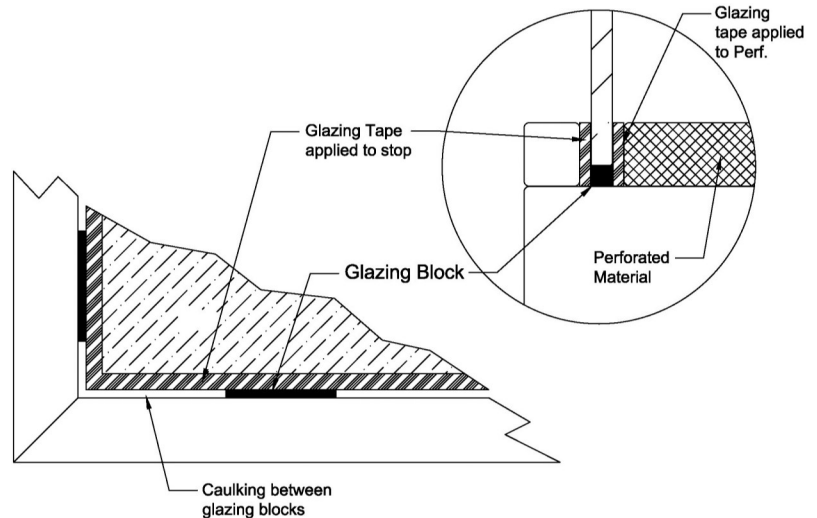

INSTALLATION INSTRUCTIONS

- Install glazing tape on the inside of the removable stops/ vision lite frame as well as on perforated material. The tape should be installed on the full height of the stop and should line up with the edge. For fire rated windows refer to local building codes for fire rated glazing tape.
- Thoroughly clean glass prior to installation. Follow manufacturer's instructions for cleaning polycarbonate and whitewater glass as certain cleaners may damage the glass.
- UL marking list must remain visible on the exterior side.
- Place glazing blocks on the frame and set glass in place. Place additional glazing blocks around the sides and top of the glass between the frame and glass. Spacing of the glazing blocks on the bottom should not exceed 24" on center.
- Apply caulking around the perimeter between the glass and frame.
- Install removable stops/ vision lite frame into pre drilled & tapped holes while applying slight pressure toward the window.
- Perforated is primed black from the factory and painted by others.