

Instructions for Adjusting KriegerSonic NC6 Magnetic Perimeter Seals

MAGNETIC SEAL ADJUSTING INSTRUCTIONS

- Rough hang the doors (butts & lock). Then, *remove caps (1) from retainers (6), beginning with the jambs, then the head.
- Loosen the screws (4) at the slotted holes (5) so the seals can be moved to make contact with the door in the latched position. Snug up some of the screws (not too tight) so that when you adjust the seal retainer, it won't bounce back. Use a hammer and a wedge shaped piece of wood (or a long standard-bladed screw driver) to adjust the seals. Place the wood wedge against the inside corner of the retainer (6), then you can use a hammer to adjust the seal without damaging the exposed surface of the retainer. Corner joints of the vinyl seal are "hot mitered" for a continuous seal. Be careful not to break this joint when adjusting the retainer. The retainer for the hinge edge is shaped a little differently, so that seal will meet the chamfered hinge edge of the door (3). Seals should be adjusted to make positive contact with the door around the entire perimeter.
- Check adjustment with a thin plastic card (8). When seals are properly adjusted, the card should fit snugly between the door and seal, it should not fall out under its' own weight at any point around the entire perimeter, At the same time, seals should, not be so tight that the card bends when inserted. If the seals are adjusted too tightly, this could cause problems with the operation of the finish hardware.
- Slam the door several times and re-check the adjustment for positive contact at the entire perimeter. Final adjustment must be done carefully to prevent sound leaks. After final adjustment, install several #10 HIWHSMS between the slotted holes, to "lock" the retainer adjustment in place. Check for any light leaks between the frame and retainer, or at the mitered corners. Close these by tightening the adjusting screws, adding screws as required, or by caulking.
- Replace the head cap first, then the caps on the jambs.

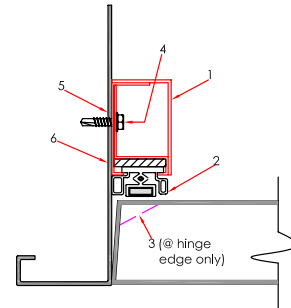

*Seal Caps are screwed (#8 PHSMS) to back of retainer

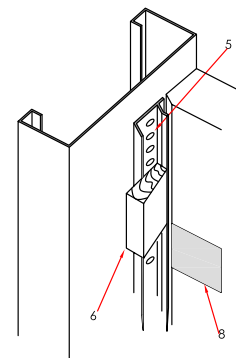

NEVER MOUNT ANY HARDWARE ON THE SOUND SEAL CAPS!

WARNING REGARDING PAINT, AND VINYL SEALS

For sound seals to work properly they must be adjusted to make positive contact with the door. There will be pressure between the vinyl seal and the painted surface of the door. The problem appears to be the paints slow release of solvent that dissolved out of the plasticizer in the gasket. To avoid this problem we recommend using a "low VOC" or "no VOC" finish paint, VOC stand for "volatile organic compound". If you have any questions, please consult a paint manufacturer for their recommendation(s) for this condition. All paint applied at our factory must comply with California Air Resources Board standards. Doors should be painted and allowed to dry completely before adjusting sound seals. The flexible sound seal itself must NEVER be painted, under any circumstance, as this will render it ineffective.