

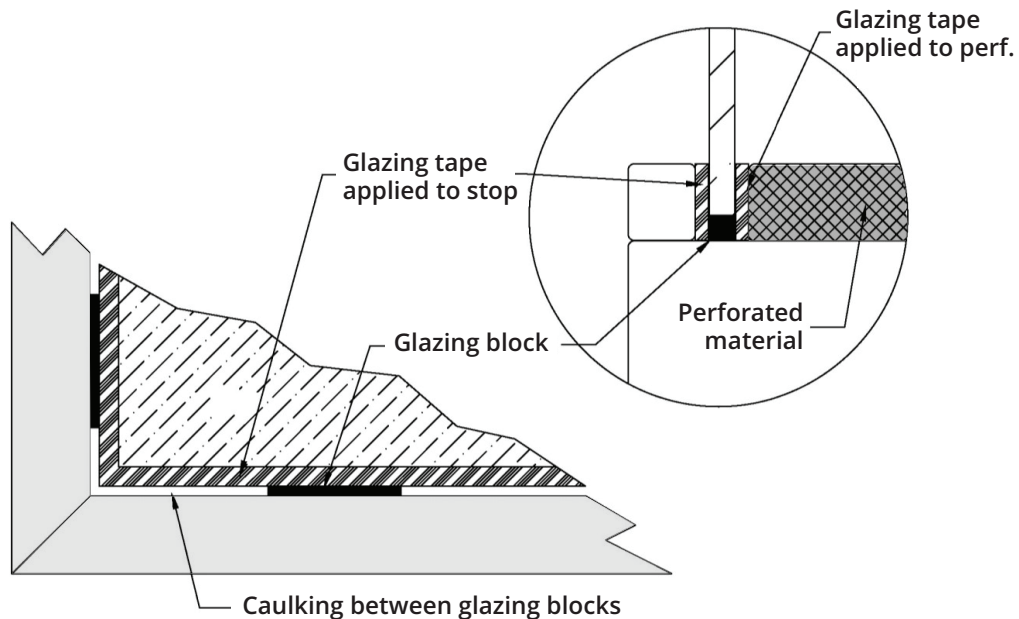

What to Know Before Getting Started

1. Materials Needed:

- Glazing blocks
- Glazing tape
- Caulking, such as DOW 995, or similar product
- **NOTE: Incorrect caulking may damage the inner layer of laminating glass.**



2. UL marking list must remain visible on the exterior side of the window.

Installation Instructions

STEP 1

- Install glazing tape on the inside of the removable stops/vision lite frame, as well as on perforated material.
 - The tape should be installed on the full height of the stop and should line up with the edge.
 - For fire-rated windows, refer to local building codes for fire-rated glazing tape.
-

STEP 2

- Thoroughly clean glass prior to installation.
- Follow manufacturer's instructions for cleaning polycarbonate and whitewater glass as certain cleaners may damage the glass.

NOTE: UL marking list must remain visible on the exterior side of the window.

STEP 3

- Place glazing blocks on the frame and set glass in place.
- Place additional glazing blocks around the sides and top of the glass between the frame and glass.
- Spacing of the glazing blocks on the bottom should not exceed 24" on center.

STEP 4

- Apply caulking around the perimeter between the glass and frame.
-

STEP 5

- Install removable stops/vision lite frame into pre-drilled and tapped holes while applying slight pressure toward the window.

NOTE: Perforated material is primed black from the factory and is to be painted by others.

End Instructions